

# Kit 1046

**CITROËN Chanson**, 3-dr Hatchback, 96-03

**CITROËN Chanson**, 5-dr Hatchback, 96-03

**CITROËN Saxo**, 3-dr Hatchback, 96-03

**CITROËN Saxo**, 5-dr Hatchback, 96-03

**PEUGEOT 106**, 3-dr Hatchback, 91-04

**PEUGEOT 106**, 5-dr Hatchback, 92-04

480R  
754

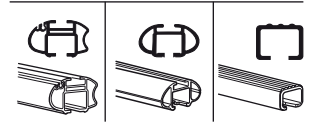
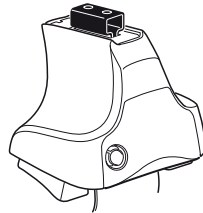

480

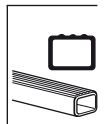
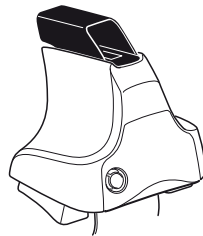

750

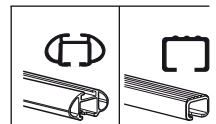
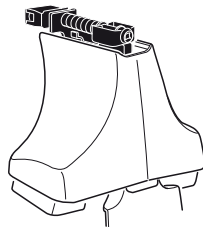



**Kit**

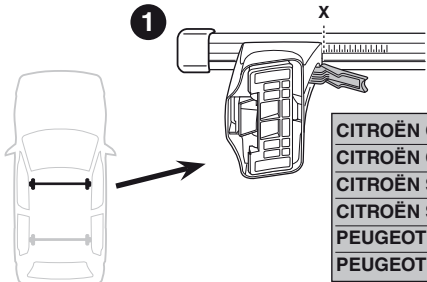
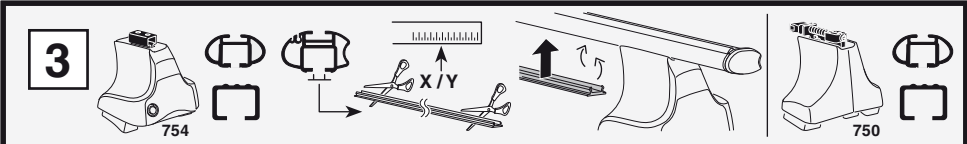

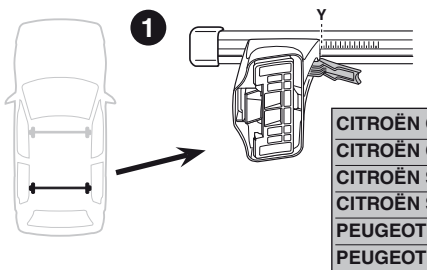
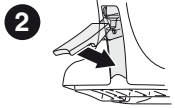

	X
<b>CITROËN Chanson, 3-dr Hatchback, 96-03</b>	21
<b>CITROËN Chanson, 5-dr Hatchback, 96-03</b>	21
<b>CITROËN Saxo, 3-dr Hatchback, 96-03</b>	21
<b>CITROËN Saxo, 5-dr Hatchback, 96-03</b>	21
<b>PEUGEOT 106, 3-dr Hatchback, 91-04</b>	21
<b>PEUGEOT 106, 5-dr Hatchback, 92-04</b>	21



	Y
<b>CITROËN Chanson, 3-dr Hatchback, 96-03</b>	18,5
<b>CITROËN Chanson, 5-dr Hatchback, 96-03</b>	20
<b>CITROËN Saxo, 3-dr Hatchback, 96-03</b>	18,5
<b>CITROËN Saxo, 5-dr Hatchback, 96-03</b>	20
<b>PEUGEOT 106, 3-dr Hatchback, 91-04</b>	18,5
<b>PEUGEOT 106, 5-dr Hatchback, 92-04</b>	20

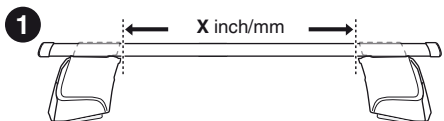
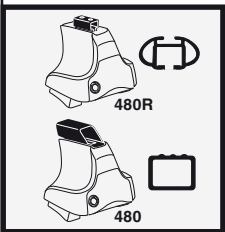

	X inch	X mm
<b>CITROËN Chanson, 3-dr Hatchback, 96-03</b>	33 <sup>7</sup> / <sub>8</sub> "	861 mm
<b>CITROËN Chanson, 5-dr Hatchback, 96-03</b>	33 <sup>7</sup> / <sub>8</sub> "	861 mm
<b>CITROËN Saxo, 3-dr Hatchback, 96-03</b>	33 <sup>7</sup> / <sub>8</sub> "	861 mm
<b>CITROËN Saxo, 5-dr Hatchback, 96-03</b>	33 <sup>7</sup> / <sub>8</sub> "	861 mm
<b>PEUGEOT 106, 3-dr Hatchback, 91-04</b>	33 <sup>7</sup> / <sub>8</sub> "	861 mm
<b>PEUGEOT 106, 5-dr Hatchback, 92-04</b>	33 <sup>7</sup> / <sub>8</sub> "	861 mm

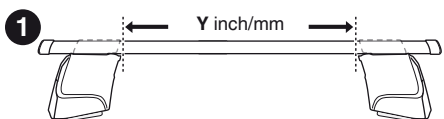
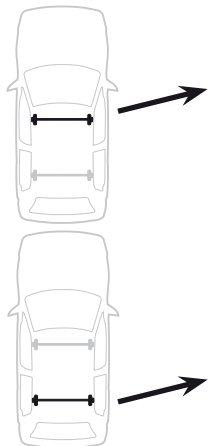
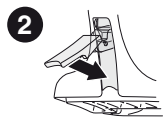

	Y inch	Y mm
<b>CITROËN Chanson, 3-dr Hatchback, 96-03</b>	32 <sup>7</sup> / <sub>8</sub> "	836 mm
<b>CITROËN Chanson, 5-dr Hatchback, 96-03</b>	33 <sup>1</sup> / <sub>2</sub> "	851 mm
<b>CITROËN Saxo, 3-dr Hatchback, 96-03</b>	32 <sup>7</sup> / <sub>8</sub> "	836 mm
<b>CITROËN Saxo, 5-dr Hatchback, 96-03</b>	33 <sup>1</sup> / <sub>2</sub> "	851 mm
<b>PEUGEOT 106, 3-dr Hatchback, 91-04</b>	32 <sup>7</sup> / <sub>8</sub> "	836 mm
<b>PEUGEOT 106, 5-dr Hatchback, 92-04</b>	33 <sup>1</sup> / <sub>2</sub> "	851 mm

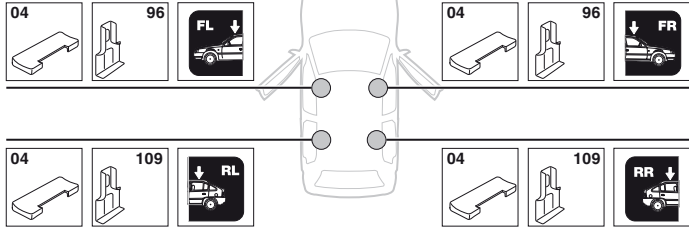
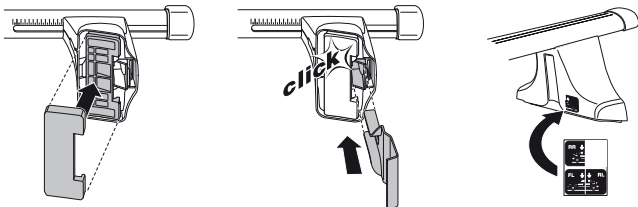
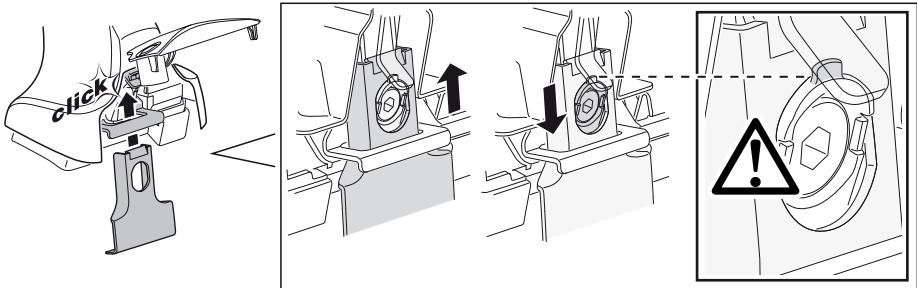
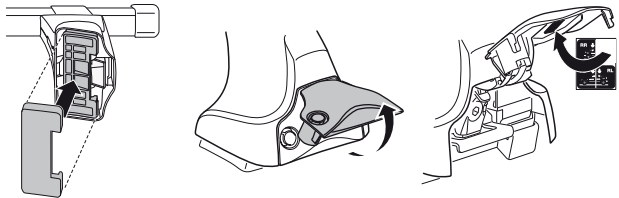
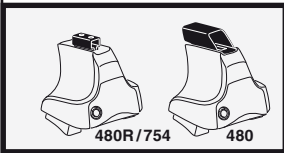
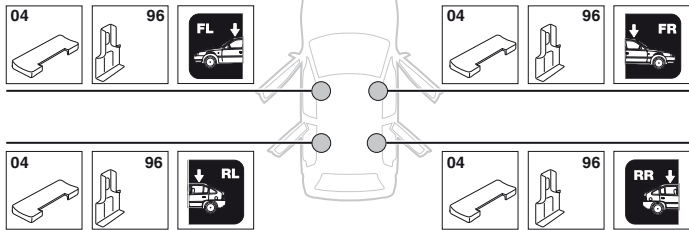

**4****CITROËN Chanson, 3-dr Hatchback, 96-03****CITROËN Saxo, 3-dr Hatchback, 96-03****PEUGEOT 106, 3-dr Hatchback, 91-04****CITROËN Chanson, 5-dr Hatchback, 96-03****CITROËN Saxo, 5-dr Hatchback, 96-03****PEUGEOT 106, 5-dr Hatchback, 92-04**

5

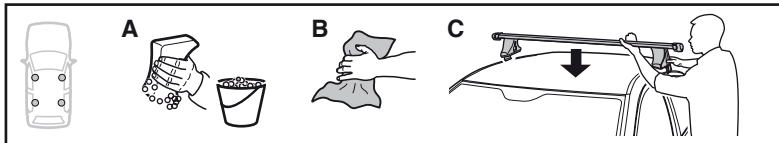

	X mm	Y mm	X inch	Y inch
<b>CITROËN Chanson</b> , 3-dr Hatchback, 96-03	220 mm	700 mm	8 5/8"	27 1/2"
<b>CITROËN Chanson</b> , 5-dr Hatchback, 96-03	220 mm	700 mm	8 5/8"	27 1/2"
<b>CITROËN Saxo</b> , 3-dr Hatchback, 96-03	220 mm	700 mm	8 5/8"	27 1/2"
<b>CITROËN Saxo</b> , 5-dr Hatchback, 96-03	220 mm	700 mm	8 5/8"	27 1/2"
<b>PEUGEOT 106</b> , 3-dr Hatchback, 91-04	220 mm	700 mm	8 5/8"	27 1/2"
<b>PEUGEOT 106</b> , 5-dr Hatchback, 92-04	220 mm	700 mm	8 5/8"	27 1/2"

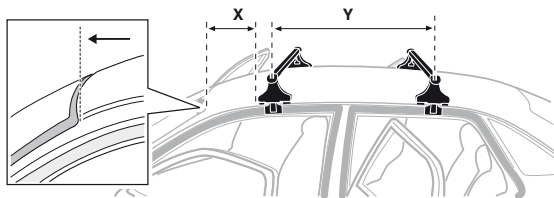

**CITROËN / PEUGEOT, 3-dr Hatchback**

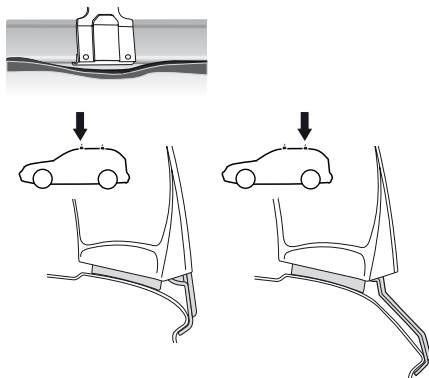

**CITROËN / PEUGEOT, 5-dr Hatchback**

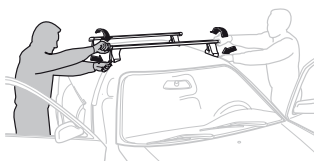
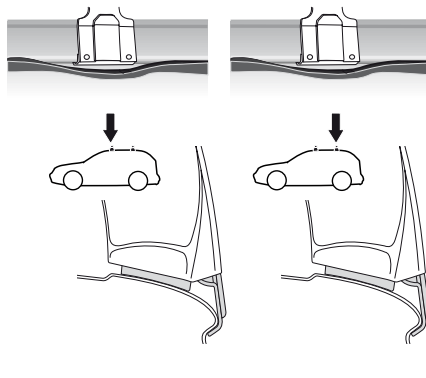

- GB/US** Tighten alternately  
**D** Die Schrauben abwechselnd anziehen  
**F** Serrer alternativement chaque côté  
**NL** Afwisselend aan de linker- en de rechterkant aandraaien  
**I** Alternare il serraggio delle viti  
**E** Apretar alternativamente  
**PT** Aperte alternadamente  
**S** Dra åt växelvis  
**FIN** Kierrä vuorotellen  
**EST** Pinguldage vaheldumisi  
**LAT** Pieļieciet pamišus  
**LIT** Užsukinėkite pakaitomis  
**PL** Śruby dokręcaj naprzemiennie  
**RU** Затягивайте попеременно

- CZ** Pokręťta багажníka dokręcaj dokręcaj naprzemiennie.  
**SK** Doťahujte striedavo  
**SLO** Privijajte izmenično.  
**HR** Naizmjenično zategnite  
**HU** Egy mástól függetlenül szorítandó  
**GR** Σφιγγείτε εναλλάξ  
**TR** Dönüşümlü sıkın  
**中文** 交替拧紧  
**한국어** 번갈아 가며 조이십시오.  
**日本語** 交互に締め付けてください。  
**ไทย** ชั้้นโน้บแบบสลับ

6



480R/754



480

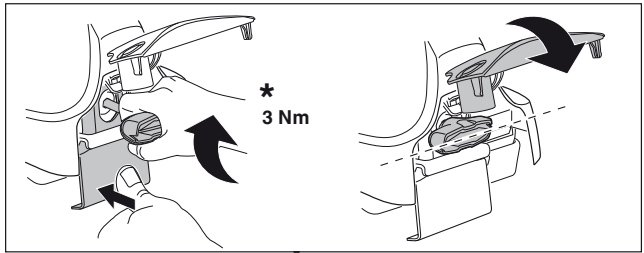
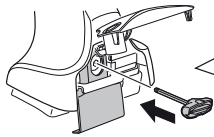

\*  
3 Nm

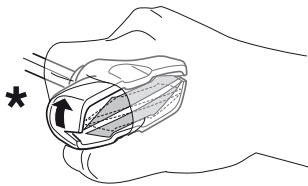

\*

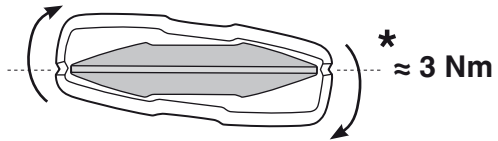

\*  
≈ 3 Nm

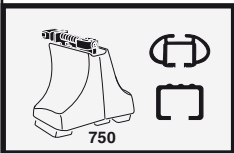
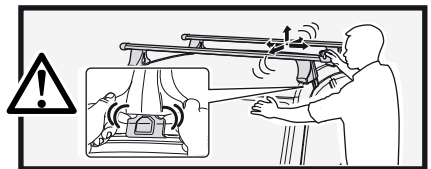

750

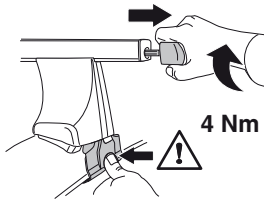

4 Nm

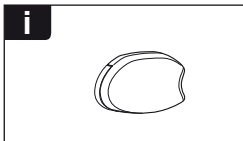
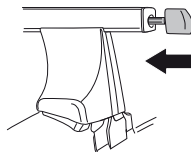

i

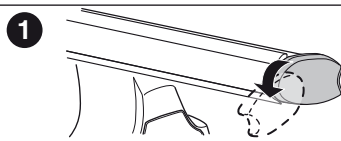

1

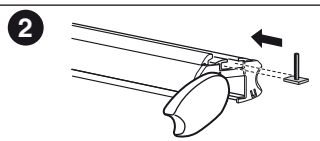

2

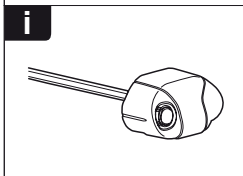

i

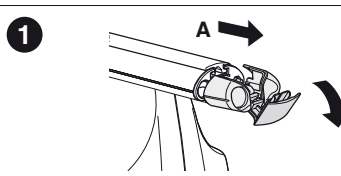

1

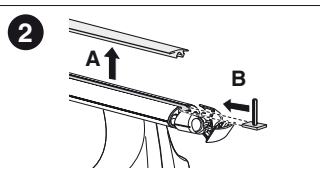

2

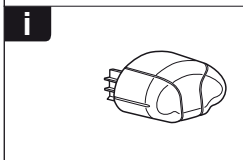

i

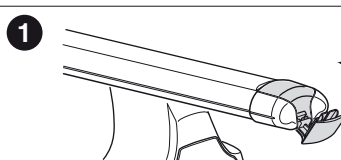

1

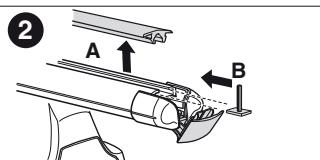

2

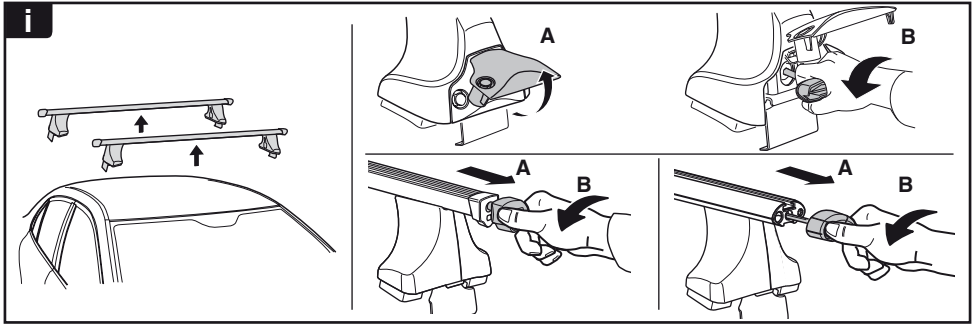

**THULE**  
SWEDEN  
**ONE  
KEY  
SYSTEM**



		(x4)
		(x6)
		(x8)
NA		(x10)
EUR		(x12)
ASIA		(x12)



WW ▶ Thule Sweden AB, Box 69, 330 33 Hillerstorp, SWEDEN  
NA ▶ Thule Inc., 42 Silvermine Road, Seymour, Connecticut 06483, USA

info@thule.com  
customer.service@thule.com

www.thule.com